

XTP: Time-lag relay

Areas of application

Adjustable attenuation of pneumatic signals, e.g. for switched (immediate) control pressures.

Features

- Front panel with printed circuit diagram for easier commissioning
- Plastic housing suitable for wall or top-hat rail mounting (rail EN 60715)
- Compressed-air connections with Rp 1/8" female thread
- Complies with directive 97/23/EC Art. 3.3 on pressure equipment

Technical description

- Supply pressure 1.3 bar ± 0.1
- Adjustable time constant between 0.2 and 3 min.



T03072



Y03176

Type	Time constant min	Air output	Air consumption	Weight kg
XTP 2 F001	0,2...3 ¹⁾	400 l _n /h	6 l _n /h	0,15
Supply pressure ²⁾	1,3 ± 0,1 bar	Permissible amb. temperature		0...55 °C
Input pressure	0...1,4 bar	Connection diagram		A02895
Output pressure	0...1,4 bar	Dimension drawing		M297107
		Fitting instructions		MV 7329

Accessories

0296936 000* Fixing bracket for rail 35 × 7,5 and 35 × 15

0297277 000 Resistor and scale for increasing the time constant to between 3 and 6 minutes

*) Dimension drawing or wiring diagram are available under the same number

1) Accessory 0297277 allows the time constant to be increased to between 3 and 6 minutes

2) See Section 60 on regulations concerning the quality of supply air, especially at low ambient temperature.

Operation

By turning the adjuster knob, the time constant T can be varied between 0,2 and 3 minutes, regardless of the capacity connected (with accessory Z 0297277, this can be increased to between 3 and 6 minutes). The relay can either supply or retract air, without impairing operation.

Connection diagram

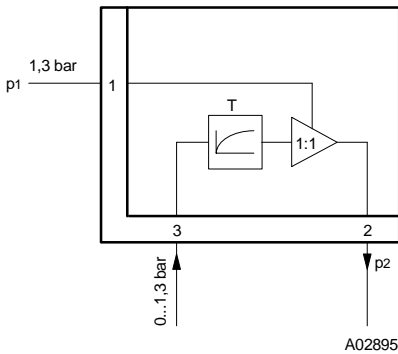

Dimension drawing

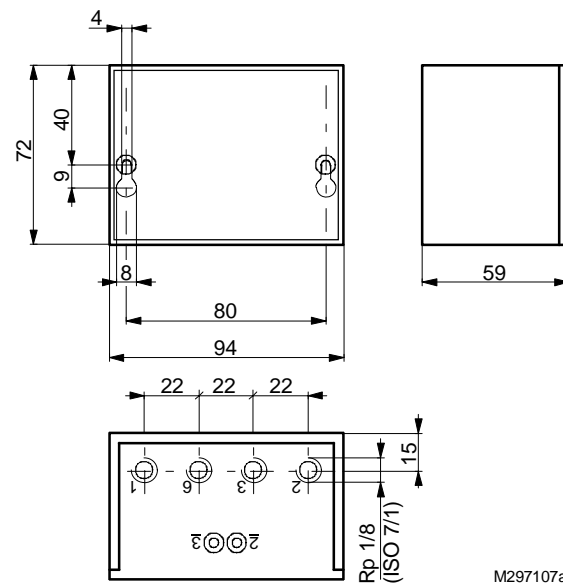

Accessories

296936

